

Premium car alarm system



Pandora DeLuxe

CAR ALARM SYSTEM

1000

DeLuxe

Quick manual

button #2
(Disarming)

button #1
(Arming)

button #3
(Function)



master remote (main unit)

button #1
(Arming)

button #2
(Disarming)

button #3
(Trunk open)



reserve remote



Call driver

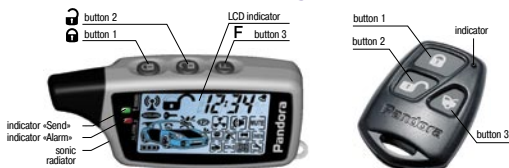

RF-module

List of the functions controlled by the buttons



	System disarmed		System armed (no alarm signals)
	Ignition switched on	Ignition switched off	
 (shortly)	Lock the doors without arming	Arming with sonic confirmation	«Tracing» mode - blinking of the turn indicators and sonic signals for 30 seconds
 (1-sec)		Arming without sonic confirmation	«Tracing» mode - blinking of the turn indicators without sonic signals for 30 seconds
 (shortly)	Unlock the doors	Unlock the doors, deactivate immobilizer	Disarming with sonic confirmation
 (1-sec)		Unlock the doors, deactivate immobilizer	Disarming without sonic confirmation
 (2-sec)	Ignition backup mode on/off		
 (shortly)	Remote's LCD brightening activation		
 (1-sec)	Trunk unlock (CH1)		
 (3-sec)	Remote control on/off		
 +  (shortly)	«Panic» mode		
 +  (1-sec)	«Anti Hijack» active mode activation		
 +  (shortly)	Arming with a running engine with sonic confirmation	Arming in 30 seconds, «Hands busy», with sound	
 +  (1-sec)	Arming with a running engine without sonic confirmation	Arming in 30 seconds, «Hands busy», without sound	
 +  (1-sec)	«Anti Hijack» passive mode activation		
 +  +  (1-sec)	Recording remotes to the system's memory. (This feature available when entering the corresponding mode of programming. All «old» remotes will be erased from the memory, the encryption key will be changed)		

Main Functions

Arming (Doors locking)

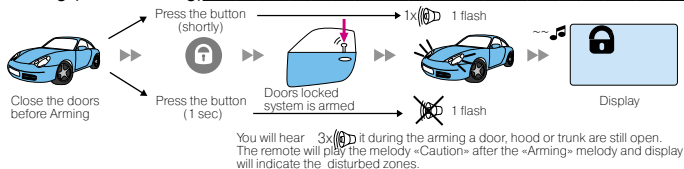

Disarming (Doors unlocking)

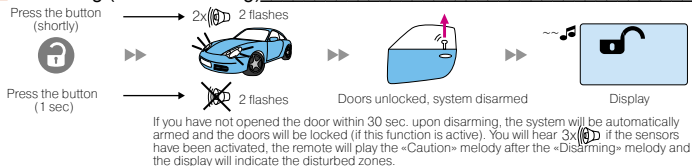

Trunk unlocking

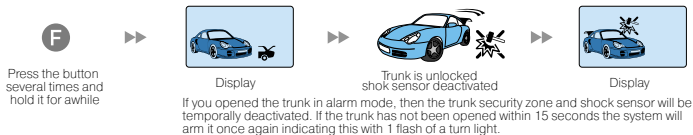

Delayed arming («Hands busy»)

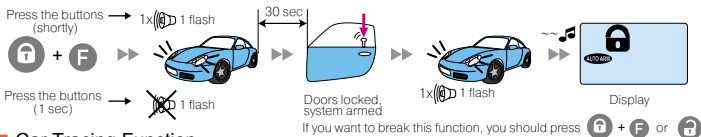

Car Tracing Function

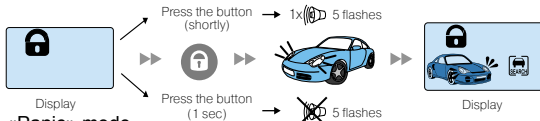

«Panic» mode

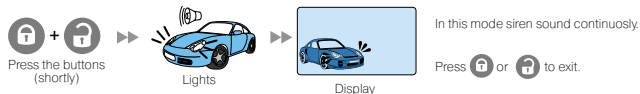

Alarm messages & status information

Alarm messages

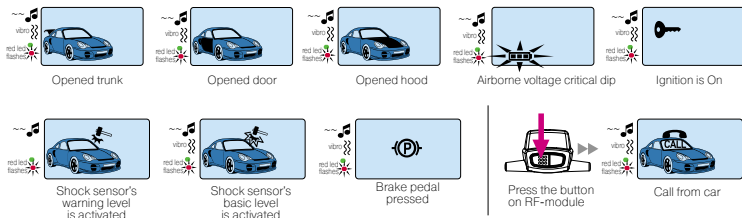

In alarm mode all the icons are blinking the melody «Alarm» is playing, vibro signal is active. If the owner has ignored the warning messages then the remote switches to the mode of reminding (single sonic signal & red flashes). Press any button to exit this mode. Shortly press the button to reset current event indication.

Status information reception

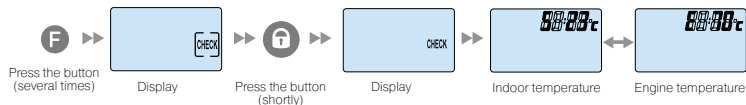

During the status info reception the remote unit retrieves the events history from the base (main unit).

LCD alarm events reading

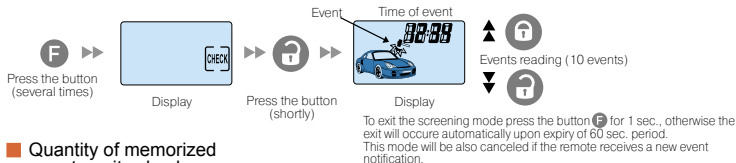

Quantity of memorized remote units check

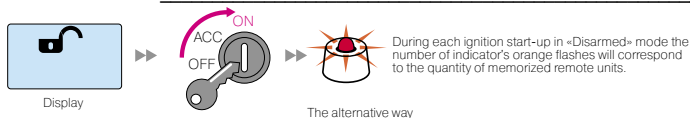

Connect - disconnect accumulator's terminal. The number of siren's signals (n) will correspond to the quantity of memorized remote units.

Default setting - 2 remote units.
One LCD remote and one extra simplex remote.



Additional features

Door locking / unlocking without arming

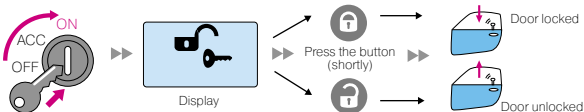

Arming / disarming with key in ignition lock

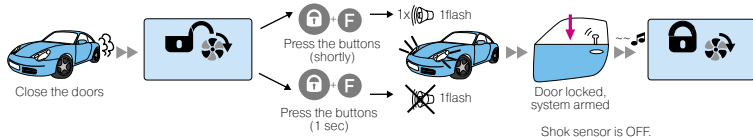

Backup of ignition with arming

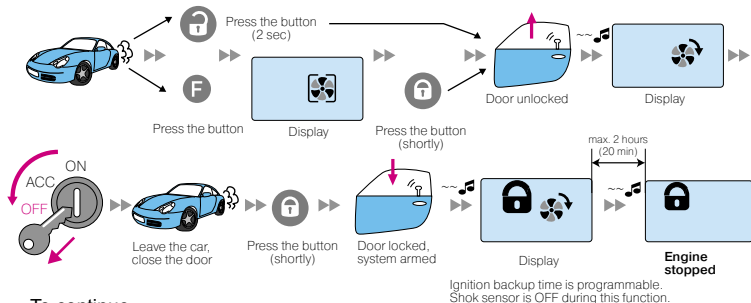

To continue

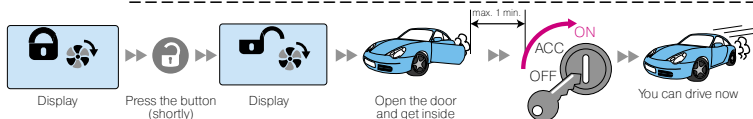

Remote mute on/off

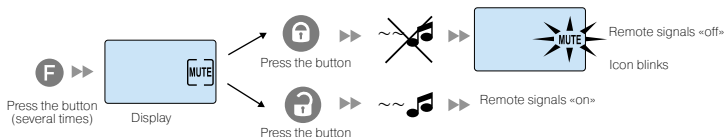

Additional features

Maintenance mode on/off

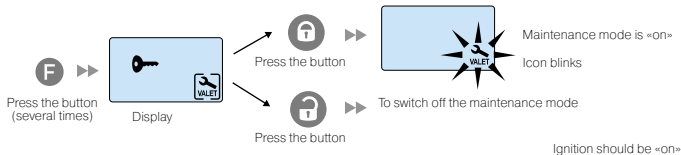

Siren mode control

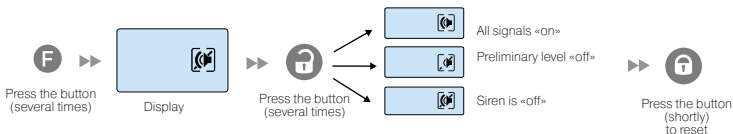

Shok sensor modes control

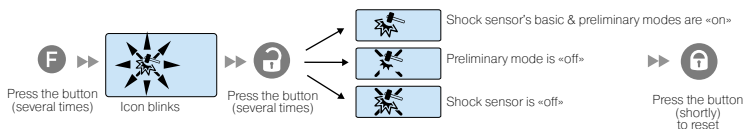

Battery replacement

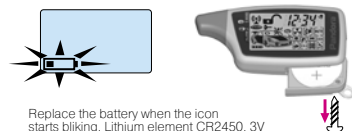

Setting the time

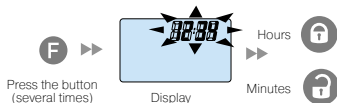

Alarm clock on/off

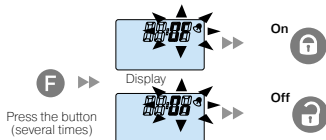

Alarm time setting

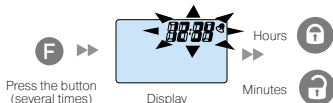

Remote unit on/off

Press and hold the button for 3 seconds

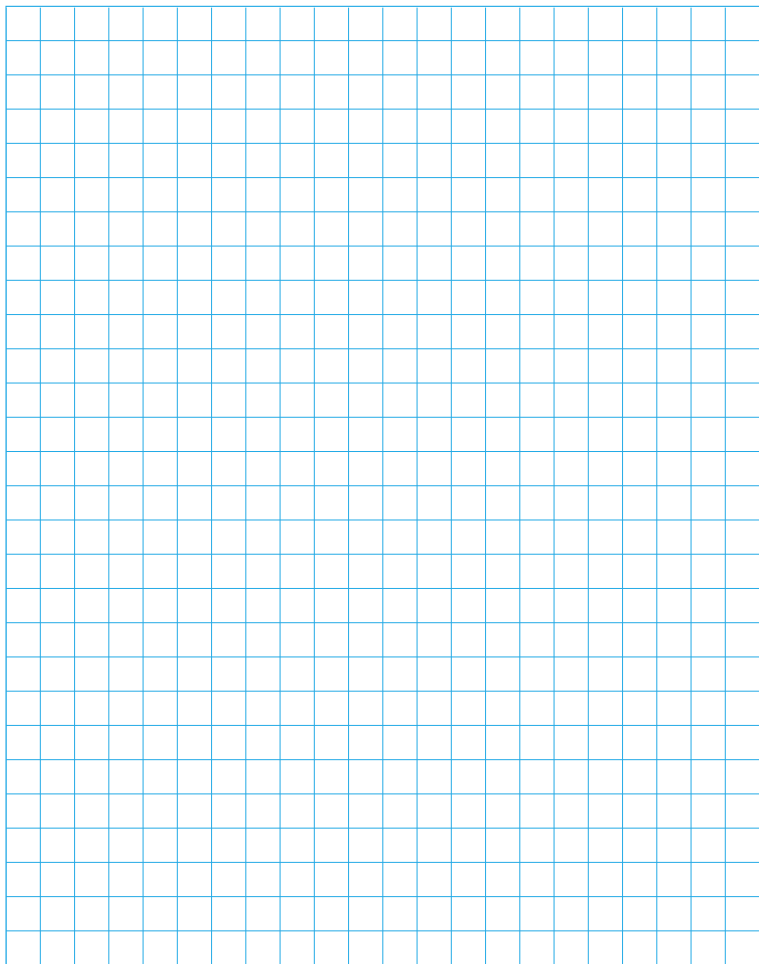

Communication
channel status

Security area
indication

Battery charging mode
indication

Security
mode status

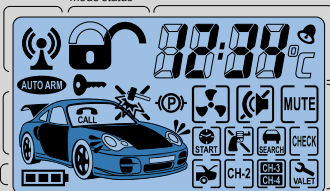

Digital indicator of
- current time
- alarm clock time
- event time
- engine on/off time
- temp. inside and engine temp.

Icons of indication and
control over the special features.
Menu of programming of the
service modes



Constantly alight:

1. Notification received
2. Command is sent, waiting for reply
3. Reply from the base received



Constantly alight:

1. System is armed (immobilizer is «on»)
2. System is disarmed



1. Constantly alight: 50-100% of charge
2. Constantly alight: 25-50% of charge
3. Blinking: less than 25% of charge



Blinking: the system is getting ready for automatic arming.
Constantly alight: the system is already armed automatically.



Blinking: in disarmed mode - ignition is being switched on. In armed mode - alarm from the ignition activation.



Constantly alight: Brake pedal is pressed.
Blinking: during engine start-up - start canceled due to unlifted hand - brake lever.



Blinking: when calling the driver by the RF-module button.

Icons blink in alarm mode during:

1. Trunk opening
2. Hood opening
3. Door opening
4. Warning lights flashing

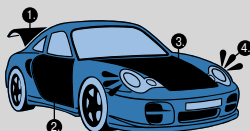

Icon choice - engine on/off

Blinking - getting ready for engine start-up.

Circling - engine is running.

Both icons blinking - engine stopped due to technical reasons.



Icon choice - siren mode

1. Warning & alarm signals «off»

2. Warning signals only «off»

3. All signals «on» due to technical reasons



Icon choice - remote's sound on/off.

Blinking - signals muted.



Icon choice - shock sensor on/off

1. Shock sensor is «on»

2. Preliminary level is «off»

3. Preliminary & warning levels are «off».



Icon choice - Engine start time set-up, daily start set-up, start temperature set-up, stop temperature set-up; warming time set-up.

«Start» icon is alight if:

- Engine's timed start-up is «on»;
- Engine's temperature start-up is «on»;
- Engine's daily start-up is «on».



Icon choice - «Anti-Hijack» mode on/off

Icon constantly displays the state of this mode.



Icon choice - vehicle tracing with or without sonic signals.

Blinking - during the command performance.



Icon choice - communication, system status, alarm events check

Icon is alight - during reception of data from the base.



Icon choice - trunk opening.

Icon is «on» - during trunk opening and is alight until it is closed.



Icon choice - timer channel #2 activation.

Icon is alight during the period of the channel work.



Icon 1 choice - activation of timer channel #3.

Icon 2 choice - activation of timer channel #4.

Icons are alight during the period of a corresponding channel work.



Icon choice - technical maintenance mode.

Is alight constantly if this mode is activated.

The icons are chosen by a multiple pressing of button «3». In most of the cases a mode is activated by the button «1» and deactivated by the button «2».